



**M.W.A WELDING (THAILAND) CO.,LTD.**

66/88 หมู่ 6 ตำบลเสาธงหิน อำเภอบางใหญ่ จังหวัดนนทบุรี 11140

โทรศัพท์: +662 903 0911-2 โทรสาร: +662 903 0916

Email: mwathailand@hotmail.com

**alkitronic®**

**designed to fit**

**Alkitronic H-AX**

## Applications

- Hydraulic torque wrench with two hydraulic hose system for tightening or loosening heavy bolt connections.
- alkitronic® H-AX** convertible type torque wrench up to 35,650 ft.lbs (49,000 Nm). Drive element with interchangeable hexagon link from 14 to 145 mm.

## Advantages

- Simple handling** and low weight.
  - Economic construction** with few single components.
  - High efficiency** with minimum maintenance requirements and low costs.
  - Hard-wearing, ergonomically shaped housing design**, made of highdensity aluminium alloy.
  - Highly flexible** due to simple, fast changing of the hexagon links.
- Trouble-free support** without affecting the torque accuracy by lateral force.

## alkitronic® specials

- Convenient, secure and reliable** individually pivoting joint couplings (360°). Capable of withstanding up to 4x higher maximum operating pressure.
- Robust ratchet with fine teeth** for high torque accuracy and a max. stroke of 28°.
- Constructive precise** guided drive element.
- alkitronic® H-AX** developed for applications in restricted space and difficult to access areas: **Drive element and hexagon link** in line, **extremely flat** and flush design.



Model **alkitronic® H-AX**

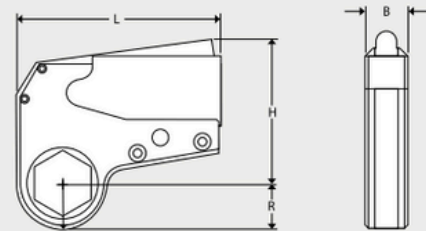

### Technical Data

Model <b>H-AX</b>							
Type		H-AX 1	H-AX 2	H-AX 4	H-AX 8	H-AX 16	H-AX 32***
Torque range (approx)*	Nm	60-770	260-2600	540-5400	1150-11900	2150-22900	4450-49000
	ft.lbs	45-560	192-1928	395-3950	830-8630	1560-16600	3220-35650
Hexagon	AF**	mm	14-32	27-55	36-70	55-95	80-115
	R	mm	19-25	26-42	34-52	46-79	63-87
Radius(approx)/from-to	R	mm	19-25	26-42	34-52	46-79	63-87
Width	B	mm	24	38	47	58	70
Length	L	mm	111	167	203	253	330
Height	H	mm	83	103	144	180	194
Weight (approx.)		kg	0.5	1.6	3.5	6.6	13

\*) When loosening a bolted connection, up to 20% higher torque may be required (loosening torque). We will gladly advise you in detail. Ask us about: \*\*) other AF sizes \*\*\*) models with larger torque range.

Important for the exact reproducibility of the specified torque is a pressure of max. 700 bar. Repeatability ±3%. For a fast, safe and reliable operation of the hydraulic torque wrenches we recommend our **alkitronic® NOVA** or **alkitronic® VELOX** hydraulic pumps (700 bar pressure, can be used worldwide in all mains grids 100-253 V / 45-66 Hz).



**alkitronic® H-AX**, when fitting a flange in plant construction.

**alkitronic®**  
HOME OF TORQUE POWER

**alkitronic® products**  
Made in Germany by

alki TECHNIK GmbH  
Development, Production and  
Distribution of Bolting Systems

Unterlettenweg 4  
85051 Ingolstadt  
Germany

fon +49 841 97499-0  
fax +49 841 97499-90

info@alkitronic.com  
www.alkitronic.com